

575-533-6062

www.openrangerealestate.com
P.O. Box 528, Reserve, NM 87830

Mary Rakestraw
Qualifying Broker / Owner

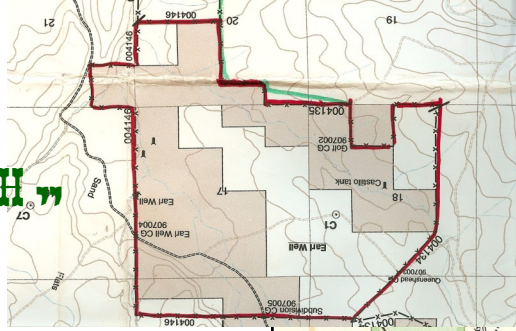
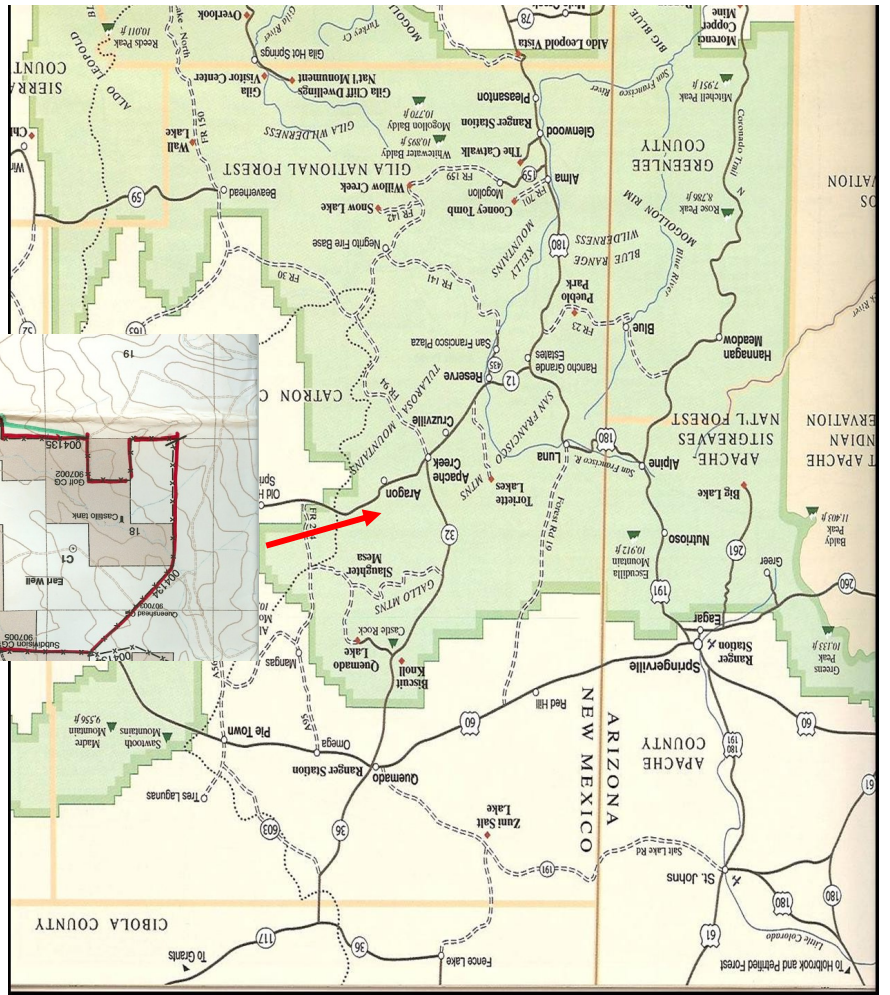

“HEART OF THE GILA”



Serving
In
Southwest
New Mexico

VISTA VERDE



Vast Views



Wildlife

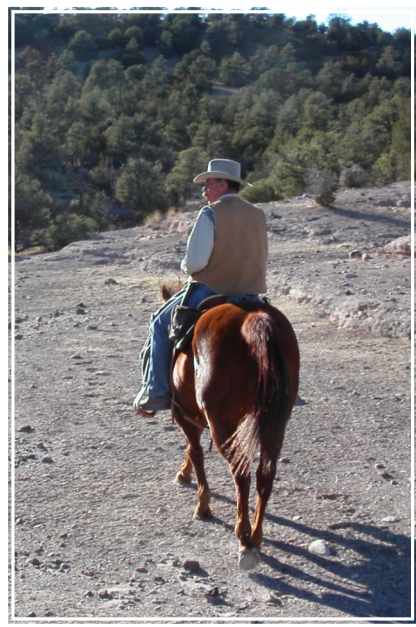

Beautiful Range Land

Dark Skies



Clean Air



The Vista Verde Ranch is nestled into the mountains of SW New Mexico bordering the Apache & Gila National Forests.

The ranch is 900 acres consisting of 70% meadows of abundant grass & colorful wildflowers and 30% wonderful rolling hills of pine & cedar.

Great ranch for cattle and horses.

There is also excellent elk, deer and antelope range out the back door and into the millions of acres of National Forest that surround Vista Verde.

Elevation is 7,200+ /- feet. Weather is in the Four Gentle Seasons area of SW New Mexico.

Accommodations include a historic adobe ranch home of 900 sq ft. , phone and generator for electric. Ranch improvements include extensive corrals with loading chute and a windmill.



Asking Price
lowered to:
\$1,299,000



2010 GMU 15

**1 Mature Bull
1 Antlerless
1 Archery Either Sex**

